

8,000 sq.ft. will be available (can be subdivided)

Adjacent to Uniprix and Maxi

3,500 sq.ft. in another building

Strategically located on a street light corner, Chemin de la Beuce (route 205) and Boulevard Cadieux

- **Fantastic visibility**
- **High traffic**
- **At proximity of Highway 30 and close to a high school**
- **A 33,000 sq.ft. Maxi grocery, 4,000 sq.ft. Uniprix and a Benny & Co Restaurant have will be built in early 2023**



MARTINE THÉRIAULT
Real Estate Broker

514.713.9764 | martine@lexiaimmobilier.ca



**CARREFOUR BEAUHARNOIS
CORNER CH. DE LA BEUCE AND BLVD. CADIEUX**

**NEW
DEVELOPMENT**

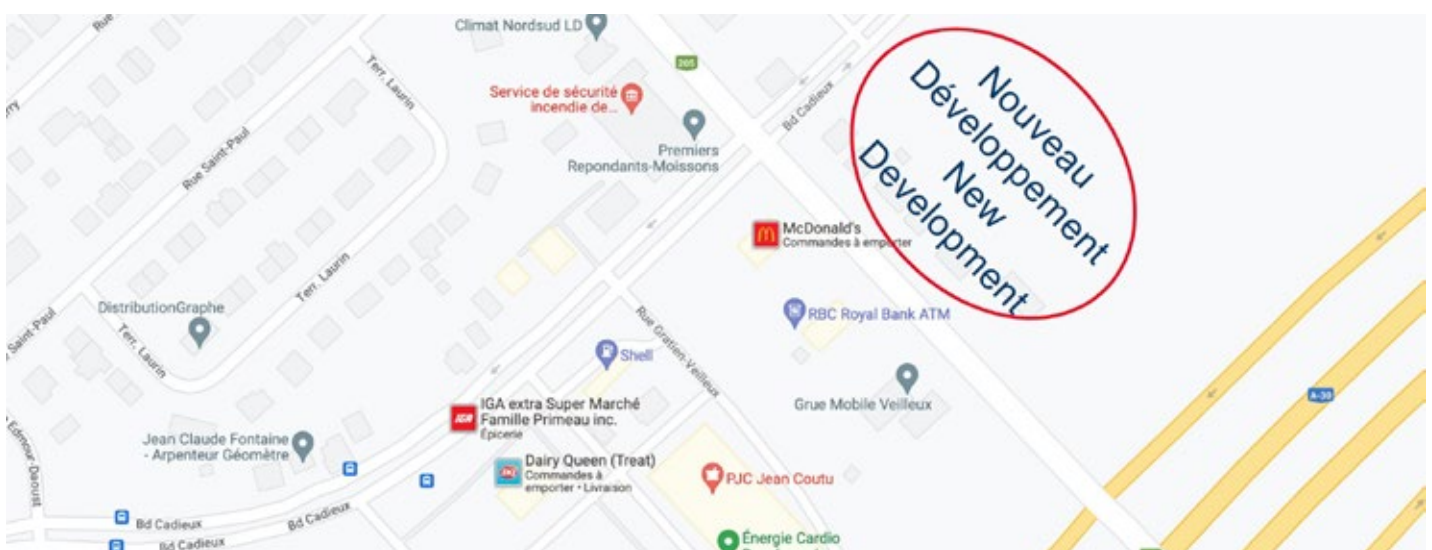
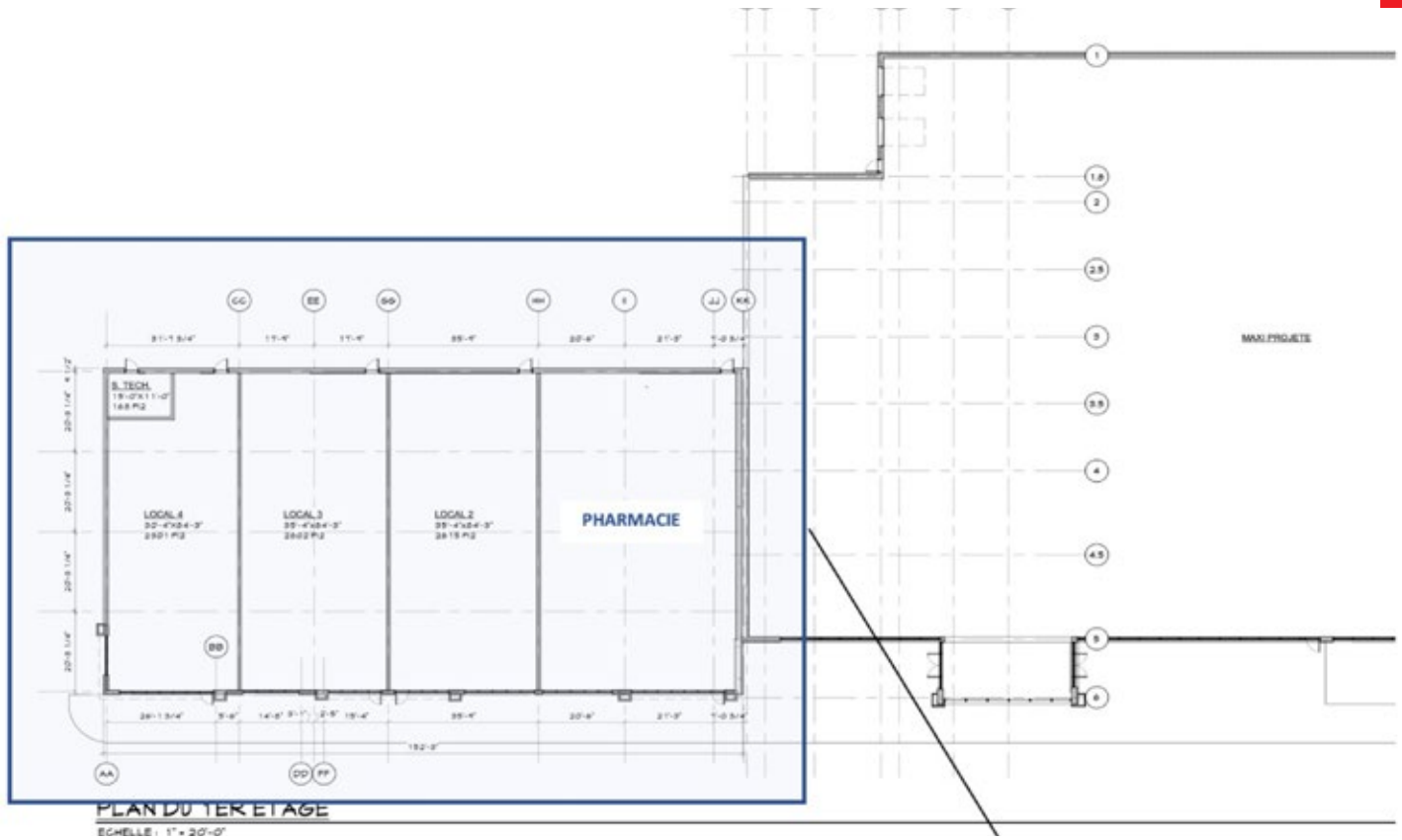

MARTINE THÉRIAULT
Real Estate Broker

514.713.9764 | martine@lexiaimmobilier.ca

